

Irma+

Renovation project commissioned by the municipal council of Rødovre, for a vacant industrial building to be used by artists. Proposal by Henrik Valeur, Thomas Kolding, Jens Jørgen Poulsen and Mette Vangsgaard, Copenhagen, 1999.

Irma's Coffee Tower is a miniature skyscraper built in 1967 in a late modernist suburb of Copenhagen. The Danish National Building Archives' index does not make a single reference to its architects Bent Mackeprang and Torkel Klerk.

Nevertheless, the building is a unique landmark of its time. But then again, maybe it is not a building. Maybe it is simply a colossal advertisement for the Irma supermarket chain.



Apart from the glazed curtain walls and the fine stone floors, unusual for a coffee processing plant, it consists of - at least conceptually - only 3 elements: a huge clock on the facade, a giant neon sign on the roof terrace, and a transparent skin fitted with nearly one hundred 1000 watt light spots, illuminating the machinery within. It was handed over to the local municipality in 1997, and has since been let out as studios to a number of artists.



Irma+ is an attempt to take advantage of a situation in which the same building houses a number of people with shared interests, working within related fields.

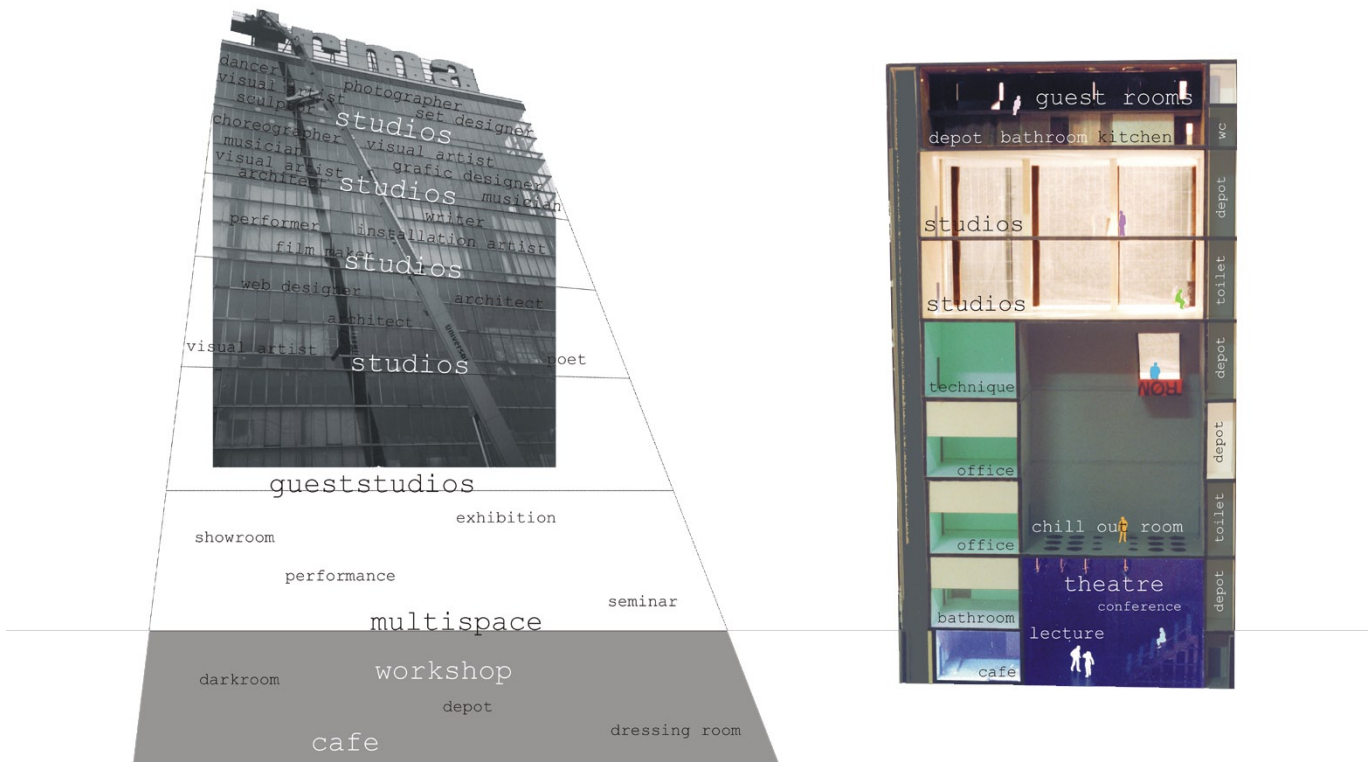

A series of physical improvements would allow a diversified range of artistic activities to unfold across conventional boundaries, making it possible to work individually, to collaborate and to make active use of the total available amount of networks, resources and energy. A contact group of 3 users, substituted one by one every month, would initiate, select and co-ordinate activities and attract guests and new users.

